

PCB LAYOUT

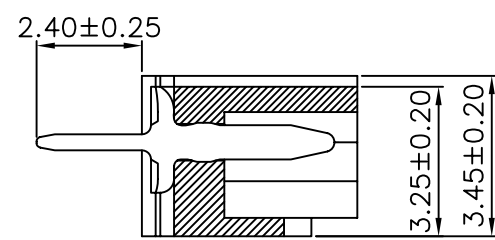

SPECIFICATIONS

Voltage rating: 125V AC, DC
 Current rating: 1A, AC, DC (AWG#26)
 Withstanding voltage: 500V AC/minute
 Insulation resistance: 100M Ω min
 Temperature range: -40 °C - +85°C
 Contact resistance: 20m Ω max

WAFER

Part No.: SCT1251WV-XXP
 Poles: 2-16
 Material: Nylon 46, UL94V-0
 Contact: Brass, Tin plated
 Q'TY: 1,000 pcs/bag

PART NO	DIMENSION	
	A	B
SCT1251WV-02	1.25	4.25
SCT1251WV-03	2.50	5.50
SCT1251WV-04	3.75	6.75
SCT1251WV-05	5.00	8.00
SCT1251WV-06	6.25	9.25
SCT1251WV-07	7.50	10.50
SCT1251WV-08	8.75	11.75
SCT1251WV-09	10.00	13.00
SCT1251WV-10	11.25	14.25
SCT1251WV-11	12.50	15.50
SCT1251WV-12	13.75	16.75
SCT1251WV-13	15.00	18.00
SCT1251WV-14	16.25	19.25
SCT1251WV-15	17.50	20.50
SCT1251WV-16	18.75	21.75

					OPERATION	DRAW	Micky.Liu	2006/05/02	SCALE		森康达电子有限公司 SCONDAR ELECTRONIC LIMITED
					~ 10	±0.15			UNIT	mm	
					20 ~ 30	±0.30			SIZE	A4	
					30 ~	±0.50			SHEET	1/1	
0	05/12/27	NEW			Angle	± 2'			PART NO.	SCT1251WV-XXP	
REV	DATE	MODIFICATION DESCRIPTION	CHANGE	APPROVE	DIM	TOL	APPROVE	Hellen.Li	TITLE:	MX1.25 180C WAFER	
								2006/05/02	DRAWING NO.	SCT1251	