

SPECIFICATIONS
 Voltage Rating: 250V AC/DC
 Current Rating: 2A AC/DC
 Withstanding Voltage: 500V AC/minute
 Insulation Resistance: 800MΩ min.
 Temperature Range: -25° C - +85° C
 Contact Resistance: 20mΩ max

TERMINAL
 Part No: SCT2508FT
 Wire Range: AWG#22-#28 (OD1.80mm)
 Material: Brass
 Finish: Tin Plated
 Thickness: 0.2mm
 Q'TY: 7,000PCS/Reel

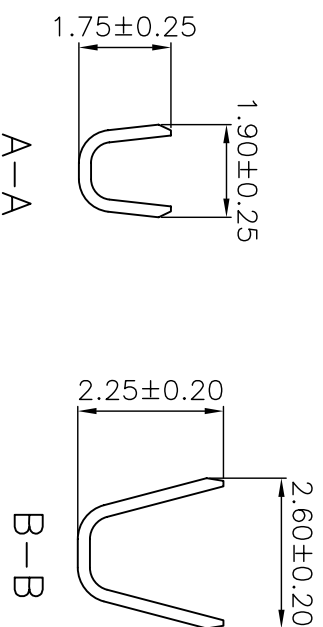
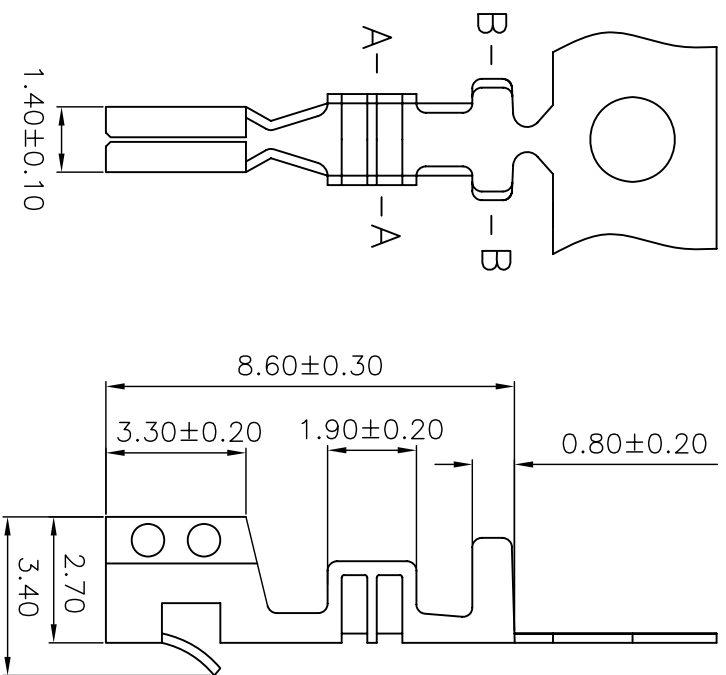

OPERATION		~ 10	±0.15	DRAW		Judy.Huang	2006/05/02	SCALE	SCONDAR 森康达电子有限公司 SCONDAR ELECTRONIC LIMITED		
DESIGN		20 ~ 30	±0.30	CHECK		Micky.Liu	2006/05/02	UNIT	A4		
ANGLE		30 ~	±0.50	APPROVE		Helien.Li	2006/05/02	SIZE	1/1		
DIM		± 2'		PROJ.				SHEET	TITLE:		
TOL.				DRAWING NO.				PROJ.	DRAWING NO.		
DATE		MODIFICATION DESCRIPTION		CHANGE		APPROVE		PART NO.		SCT2508FT	
05/12/27		NEW						Molex 5102 TERMINAL		SCT2508	
1		2		3		4		5		6	
7		8		9		10		11		12	