

P.C.B LAYOUT

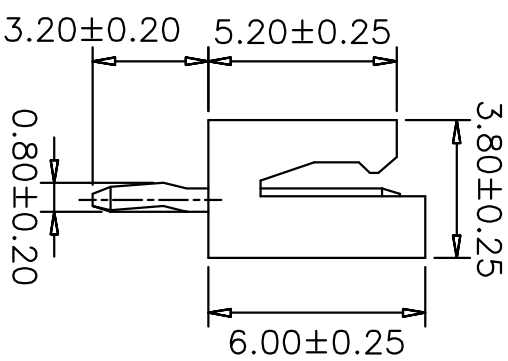
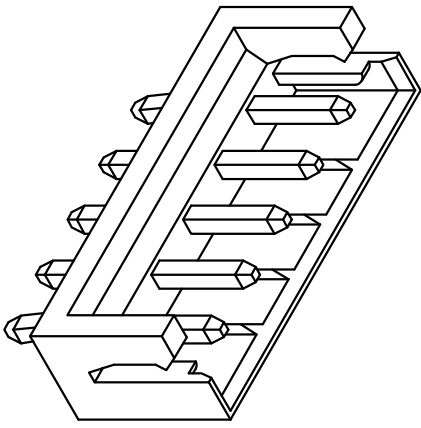
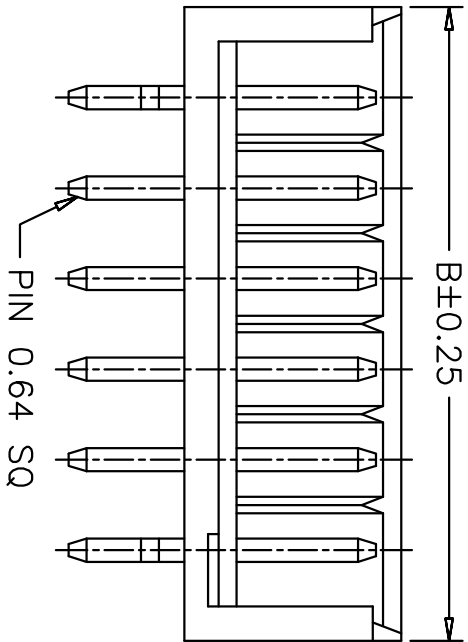
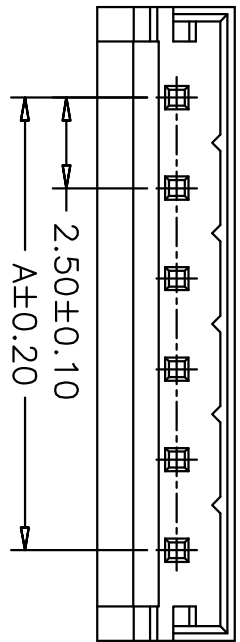

SPECIFICATIONS
 Voltage Rating: 250V AC/DC
 Current Rating: 3A AC/DC
 Withstanding Voltage: 800V AC/minute
 Insulation Resistance: 1000MΩ min.
 Temperature Range: -25° C - +85° C
 Contact Resistance: 20mΩ max

WAFER
 Part No: SCT2511WV-XXP
 Poles: 2-15
 Material: Nylon 66, UL94V-0
 Pin: Brass, Tin plated

PART NO.	Dimensions	
	A	B
SCT2511WV-02P	2.50	7.50
SCT2511WV-03P	5.00	10.00
SCT2511WV-04P	7.50	12.50
SCT2511WV-05P	10.00	15.00
SCT2511WV-06P	12.50	17.50
SCT2511WV-07P	15.00	20.00
SCT2511WV-08P	17.50	22.50
SCT2511WV-09P	20.00	25.00
SCT2511WV-10P	22.50	27.50
SCT2511WV-11P	25.00	30.00
SCT2511WV-12P	27.50	32.50
SCT2511WV-13P	30.00	35.00
SCT2511WV-14P	32.50	37.50
SCT2511WV-15P	35.00	40.00

OPERATION	~ 10	±0.15	DRAW	CHENA	05/12/27	SCALE	
	20 ~ 30	±0.30	DESIGN			UNIT	mm
	30 ~	±0.50	CHECK	MICKY	05/12/27	SIZE	A4
ANGLE	± 2'		APPROVE	HELLEN	05/12/27	SHEET	1/1
DIM	± 2'					PROU.	
DATE	05/12/27		CHANGE			DRAWING NO.	SCT2511
REV	0	NEW	DESCRIPTION				

SCT 森康达电子有限公司
 SECONDAR ELECTRONIC LIMITED

PART NO. SCT2511WV-XXP
 TITLE: EH2.5 180C Wafer