

A
B
C
D
E
F
G

A
B
C
D
E
F
G

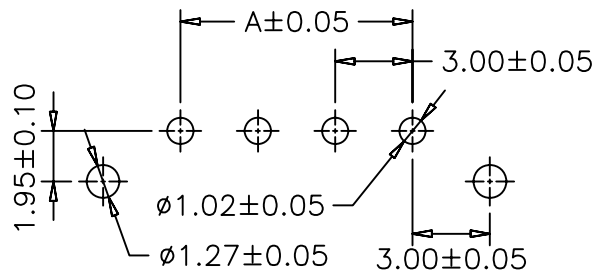
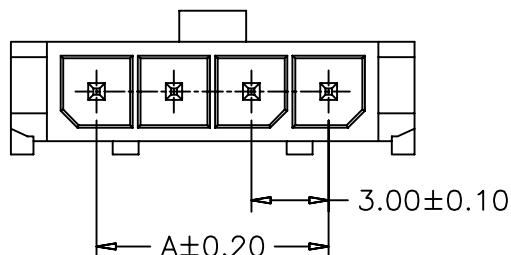

P.C.B LAYOUT

SPECIFICATIONS
 Voltage Rating: 250V AC/DC
 Current Rating: 5A AC/DC
 Withstanding Voltage: 1500V AC/minute
 Insulation Resistance: 1000MΩ min.
 Temperature Range: -25° C - +85° C
 Contact Resistance: 20mΩ max

WAFER
 Part No: SCT3001WV-XXP
 Poles: 2-12
 Material: Nylon 66, UL94V-0
 Pin: Brass, Tin plated

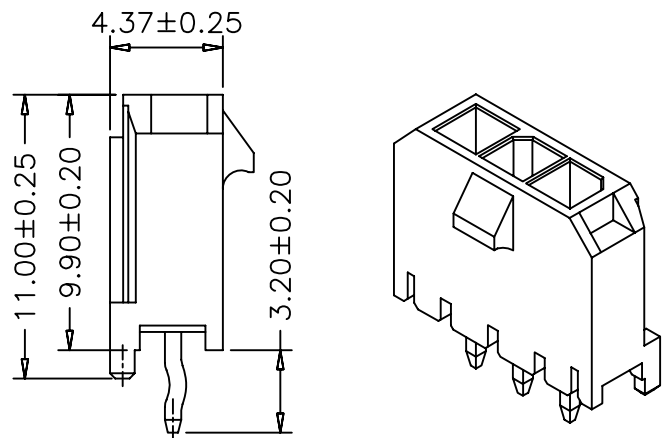
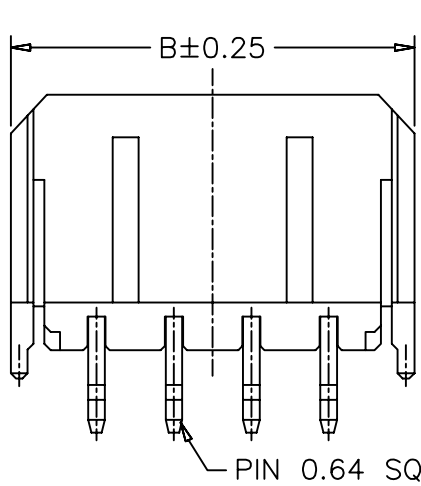

PART NO.	Dimensions	
	A	B
SCT3001WV-2P	3.00	9.65
SCT3001WV-3P	6.00	12.65
SCT3001WV-4P	9.00	15.65
SCT3001WV-5P	12.00	18.65
SCT3001WV-6P	15.00	21.65
SCT3001WV-7P	18.00	24.65
SCT3001WV-8P	21.00	27.65
SCT3001WV-9P	24.00	30.65
SCT3001WV-10P	27.00	33.65
SCT3001WV-11P	30.00	36.65
SCT3001WV-12P	33.00	39.65

					OPERATION	DRAW	JUDY	2007.05.09	SCALE		森康达电子有限公司 S'CONDAR ELECTRONIC LIMITED	
					~ 10 ±0.15	DESIGN			UNIT	mm		
					20 ~ 30 ±0.30	CHECK	MICKY	2007.05.09	SIZE	A4	PART NO.	SCT3001WV-XXP
0	05/12/27	NEW			30 ~ ±0.50	APPROVE	HELLEN	2007.05.09	SHEET	1/1	TITLE:	MOLEX3.0 180C WAFER
REV	DATE	MODIFICATION DESCRIPTION	CHANGE	APPROVE	Angle DIM ± 2° TOL	APPROVE	HELLEN	2007.05.09	PROJ.	DRAWING NO.	SCT3001	